

THE STONECHAT

110V Heavy Duty Stone Grinder & Polisher

Swish®

The World's Most Powerful (and VERSATILE) 110V Stone Grinder & Polisher

★★★★★ 5-Star Rating: Value for Money



Plugs into any standard 110V 15A outlet (and handles up to **400 lbs of additional weight** to grind floors faster)



Integrated SplashGuard with dust port keeps the work area **clean & dust-free.**



Built-in amperage meter with shows you how much weight you can safely add **without tripping the breakers.**



Offset handle helps **reduces fatigue** on the operator.



Converts easily to a **countertop grinder & polisher.**



MADE IN
CANADA

"highly effective, extremely durable and cost effective"

—Brian Gingras, CBSE President Bee-Clean Building Maintenance

If You Need to Grind Floors or Restore & Refinish Stone Surfaces (And Even Countertops) ...You Need the Centaur Stonechat Machine



The Stonechat is the world's most POWERFUL 110V stone floor grinder and polisher.

It's built for heavy duty work. This beast stands and grinds with some serious torque & weight (400lbs if needed).

It's ideal for grinding, refinishing & rejuvenating the toughest hard floor surfaces - including granite, marble and terrazzo.

From the moment you turn on the Stonechat you know you're using a machine that will refinish a floor to perfection.

Convert the Stonechat to a Mini and you now have a machine that makes it easy to work on marble/granite/quartz countertops in any home or business... just so you have another excuse to make more money using the Stonechat!

The Stonechat

Heavy Duty Stone Grinder & Polisher



The Stonechat's versatility allows you to use the machine for more than just a stone grinder/polisher. This machine can also be used as floor sander, a floor maintainer for scrubbing & stripping, and even a baseboard cleaner.



Get two grinding paths from the same machine by downsizing the Stonechat from 18" to 13".



The integrated SplashGuard on the Stonechat prevents liquids from spraying onto walls, and has a dustport for a vacuum cleaner. This helps reduce airborne dust from dry grinding.



If you need more downward pressure to grind faster, the Stonechat accommodates up to 400lbs of additional weight.



The Stonechat-Mini

13" Countertop Grinder & Polisher



The Stonechat-Mini sports the same power as its big brother.



The shortened handle makes it the perfect solution for working on countertops, work benches, tabletops, retaining walls and raised surfaces.



If you already own a Stonechat, all you need to do is replace the floor handle with a "Mini" handle to convert it to a Stonechat-Mini.



A flex 13" SplashGuard is available to help prevent the slurry from splashing and containing dust while grinding.

13 Design Features That Make The Stonechat Easier & Faster to Operate

1) Offset Handle

Reduces fatigue on the operator when using the machine over long time periods.

2) Power Indicator Light

Know when the machine is connected to a working power outlet. It's common to find outlets that don't work (due to blown fuses) and it can be frustrating not knowing that's the problem when you plug in a machine and it doesn't turn on.

3) Twist-Lock Power Cable

Allows you to remove the power cable for easier transportation of the machine. When the power cable wears out or gets damaged, it's easy to replace and costs you less, unlike machines with fixed cables where you need a service technician to replace the cable for you. The twist-lock makes sure the power cable stays secure and never detaches as you move the machine around.

4) Soft Start/Stop Motor

Provides safer operation of the machine and prevents the "jump" start where a machine can get away from your hands and possibly cause injury.

5) Add More Weight

The Stonechat is designed to accommodate up to an additional 400 lbs of weight to give you the pressure needed to grind faster.

6) Integrated Splashguard with Dustport

Prevents liquids from spraying on walls, and has a dustport for a vacuum cleaner. This helps to reduce airborne dust which could be harmful during dry grinding.

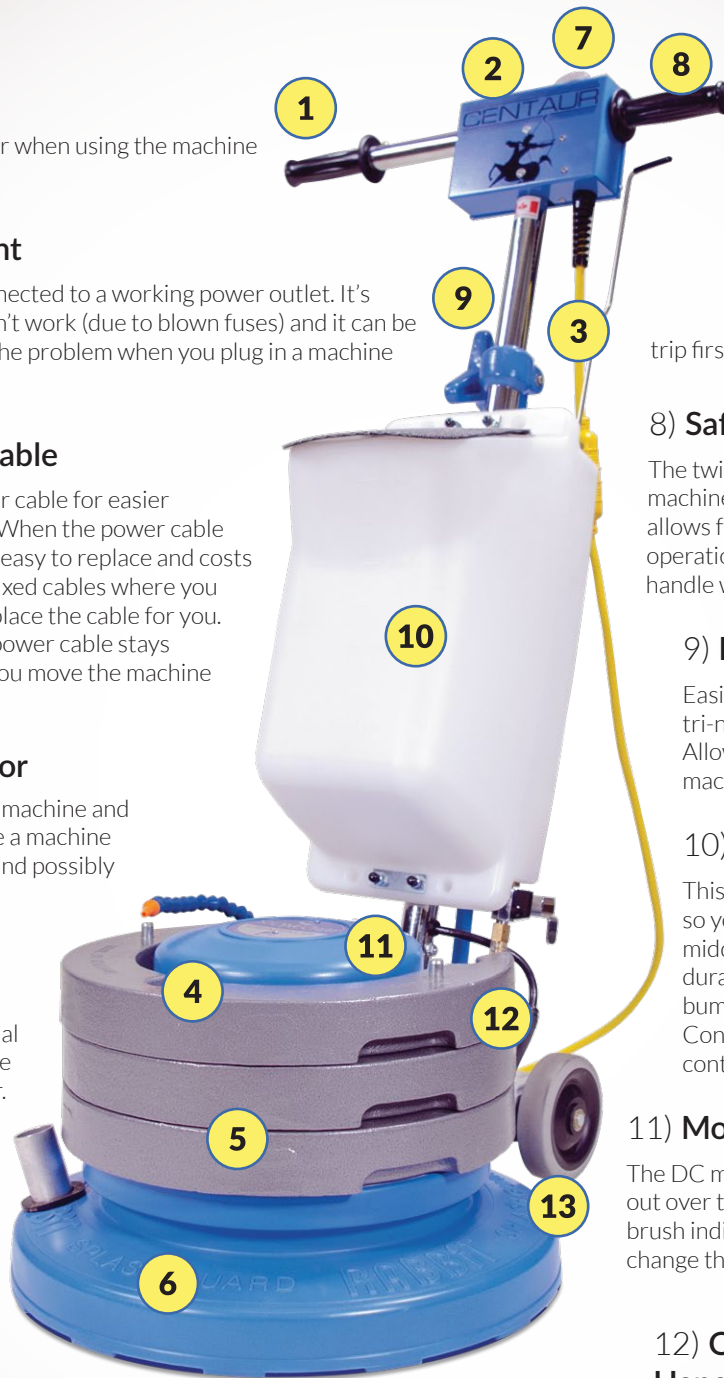

7) Onboard Fuse & Amperage Meter

During grinding, as friction builds the amperage increases. This could trip the panel circuit breakers resulting in unnecessary work stoppage. An on-board amperage meter helps you monitor this, and the onboard fuse will trip first before the circuit breaker trips.

8) Safety Button/Twist Grip

The twist grip rotates forward to activate the machine, with a slight adjustment to the wrist, it allows for ease of use over many hours of operation. For safety, a simple release of the handle will stop the machine.

9) Handle Height Adjustment

Easily adjust the handle height by turning the tri-nut (without you having to bend down). Allows you to comfortably operate the machine at your hip height.

10) Deluxe Water Tank

This tank holds a generous 4 gallons of water so you don't have to stop and refill it in the middle of your job. The tank is fitted with a durable neoprene lid to prevent spillage when bumping the machine against the baseboards. Control the flow of water using the fingertip control during operation.

11) Motor Servicing Light

The DC motor uses carbon brushes which wear out over time. The Stonechat includes a carbon brush indicator that lets you know when it's time to change the brushes.

12) Quick Detachable Handle/Cord

Pull pins allow you to detach the handle from the base for easy transportation in any car. Detaching the handle also reduces the weight of the machine if you need to carry it up the stairs.



13) Premium Non-Marking Wheels

The wheels on the Stonechat are rugged, chemical resistant and designed not to leave a mark when transporting the machine.

"the water tank and 40 lbs weight makes the machine's versatility impressive"

—Dustin Chang, FCH Maintenance



Compare & Choose Your Stonechat Package

	Starter Package (#2W220-4)	Complete Package (#2W220-5)	Stonechat-Mini Package (#2W220-9)
	 <p>Stonechat Single speed 175 RPM, 1.5 HP DC Motor, 50 ft Electric Cord</p>	 <p>Stonechat Single speed 175 RPM, 1.5 HP DC Motor, 50 ft Electric Cord</p>	 <p>Stonechat-Mini Single speed 175 RPM, 1.5 HP DC Motor, 50 ft Electric Cord</p>
Deluxe Water Tank (w/ stainless steel handle + drain plug)	✓	✓	
SplashGuard With Dustport	✓ 18" (removable for downsizing)	✓ 18" (removable for downsizing)	✓ 13" Flex SplashGuard
Horseshoe Weights	✓ (3 x 40 lbs)	✓ (3 x 40 lbs)	✓ (1 x 40 lbs)
18" Oriol Plus Drive Block (w/ center lock)	optional	✓	
Magpie Diamond Holder (w/ 6 velcro cub discs)	optional	✓ 18" Plastic Magpie	✓ 13" Plastic Magpie
<p>If you already own a Stonechat, get the Stonechat-Mini Conversion Kit #2C01700 (includes: Short handle with 50' cable, 13" Flex SplashGuard and 13" Magpie with 6 cub discs)</p>			

"its versatility, dependability is unparalleled within our organization"

—Michael P. Hurley, former President & Co-CEO Hurley Corporation

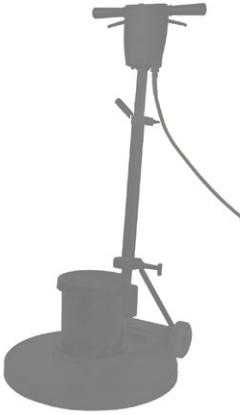
What Makes The **STONECHAT** **DIFFERENT** From Others?

	Other Machines	Stonechat
		
Integrated Splashguard (removable)	No	✓
Downsizes from 18" to 13"	No	✓
Baseboard Cleaning	No	Available
Accommodates Weights	Some	✓
Dust Port Attachment	Some	✓
Made In Canada	No	✓
Typical Lifespan	5–10 Years	15–20 Years

Stonechat Technical Specification

STONECHAT	Part #: 2W220-6	Detachable Electric	Yes (twist lock)
Primary Application	Hard Stone or Concrete	Cord Electric Cord Length	50 ft (15.24 m)
Electrical Supply	120V – 15 AMP – 50/60 Hz	Machine Weight (w/o cord)	79.1 lbs (35.9 kg)
Drive Block Size	18"	Weights Supported	up to 400 lbs (181 kg)
Downsizes To	13"	Removable SplashGuard	Yes
Drive Block Speed	Single Speed: 175 RPM	Flex Hose Sprayer	Yes
Motor	DC 1.5 HP - High Torque	Supports Baseboard Cleaning	Yes
Noise Level	63 dB	Dust Port Attachment	Yes
Detachable Handle	Yes	Water Tank (16 L/4 G)	Yes

"still in service over ten years"

—Brian Gingras, CBSE President Bee-Clean Building Maintenance

Options & Accessories



13" Flex SplashGuard

Prevents spraying the mess onto nearby surfaces during operation.
(#2E94027)



17" TYNEX Tile & Grout Brush & Pad Combination

Ideal for scrubbing vinyl, terrazzo, marble, granite and cleaning narrow grout lines and uneven surfaces.
(#2A71786)



Scrub Jay #3

Designed to fit on to The Stonechat machine for baseboard cleaning.
(#2A81356)



Scrub Jay #4

For cleaning taller baseboards (up to 8") in combination with Scrub Jay #3. (#2A81358)

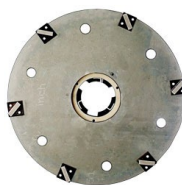

18" Aluminum Magpie with 16 grit Diamond Gimlets

A highly versatile tool, designed to grind concrete & hard stone lippage. Excellent for removal of epoxy, mastic and glues, as well as prepping the surface for new coatings. This Magpie can be fitted with other diamonds and cup wheels to complete your grinding / polishing needs. (#2A81844)



18" Magpie Diamond holder with Velcro Cub Discs

Holds velcro backed diamonds. This is the ideal tool to polish and hone fast. (#2A81840)



40 lb Horseshoe Weight

For faster stripping, cleaning, polishing, grinding and scrubbing.
(#2F03072)



For Pricing or To Request a Demo

The Swish logo, featuring the word "Swish" in a red, stylized script font with a registered trademark symbol.

phone: 1-855-467-9474

email: info@swish.ca

www.swish.ca